

Quick Guide

Cerebral State Monitor CSM-2

1 Prepare the skin, place and connect sensors to the CSM patient cable

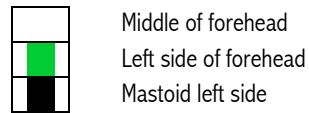
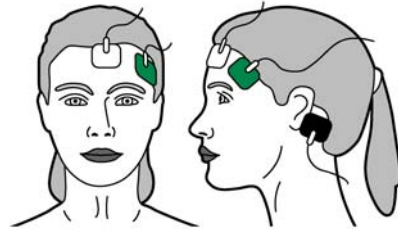
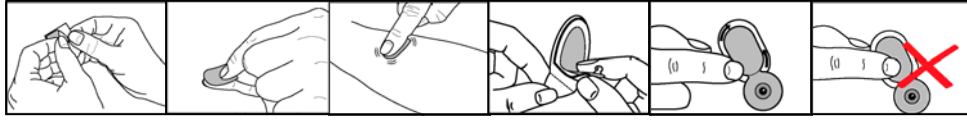

Shown above is left sided setup; right sided is also acceptable

OBS:

Facialis EMG may increase the CSI under certain conditions.
Please refer to User Manual, section 5.4.

2 Connect patient cable to the CSM monitor

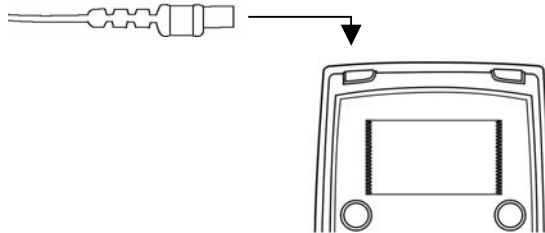

3 Press the Power On button CSM information is immediately available

 **danmeter**
Phone.: +45 63 11 29 30
www.danmeter.dk

PN 561100106-03

Operation Display

D			<p>CSI trend histogram with 5-minute interval showing average, lowest and highest CSI values within the interval. EMG% is displayed as a bar in the right panel.</p>
C			<p>CSI trend curve with event markers and BS curve. EMG% is displayed as a bar in the right panel. Operation time and numeric value of the actual CSI and BS%.</p>
B			<p>Displays 3 seconds of EEG waveform. Use Event key to scale up and down.</p>
A			<p>Main information window with CSI, BS%, EMG%, SQT%, clock, operation time and battery operation.</p>
E			<p>Sensor impedance, CSI, BS%, clock and operation time. When display E is active, the sensor impedance is updated every 60 seconds. Press Display key down firmly for immediate impedance update.</p>

The CSM always starts with display A.

Battery installation and charging

- Insert the battery CSMX04 correctly into the compartment
- Connect the CSM-Power adapter to the Charge connector on CSM
- Connect mains to CSM-Power adapter
- Check Charge indicator = green
- Fully charged battery in about 4 hours

- | | |
|--|---|
| | Battery about 50-percent charged |
| | Battery charging when icon animates |
| | Battery fully charged (if not animated) |

ONLY a CSM Battery (CSMX04) is to be charged in CSM Monitor

Optional 9V Alkaline operational

